

# SANDUSKY COUNTY, OHIO

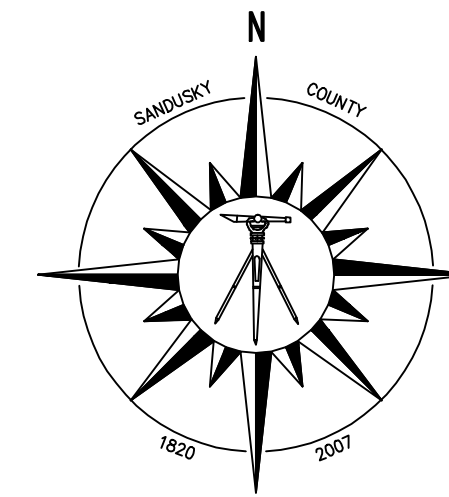

prepared by the office of  
JAMES R. MOYER  
SANDUSKY COUNTY ENGINEER  
2500 WEST STATE ST  
FREMONT, OHIO  
2007

GEOGRAPHICAL LOCATION  
EAST from 1st Principal Meridian - Ohio - Indiana Line  
NORTH from 41st Parallel - Seneca - Crawford County Line

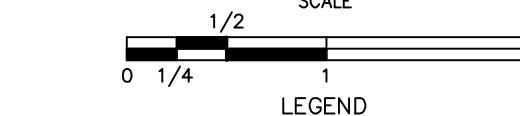

- COUNTY ROADS
- TOWNSHIP ROADS
- PRIVATE ROADS
- STATE & FEDERAL ROUTES
- OHIO TURNPIKE
- NORTH COAST INLAND BIKE PATH
- CHURCH
- CEMETERY

